

# Garden of Peace Memorial Columbarium



Niches for the reverent interment of cremains in Mercy's new Garden of Peace Columbarium are available for purchase. Each niche offers space for the cremains of two people.

**\$5,800** for an 8 inch square niche / capacity 2 cremains

**\$8,500** for a 12 inch square niche / capacity 2 cremains

## INCLUDED IN BOTH PRICES

- + Two Burials per crypt
- + Opening and closing of the columbarium space
- + Inscription (handled by management); Military Insignia also available
- + Two bronze sheet metal urns
- + Perpetual Maintenance

## CATHOLIC FUNERAL WITH CREMATION

The choice to cremate and the interment of sacred cremains is a reverent funeral option for Catholics. In May 1963, the Vatican Congregation of the Doctrine of Faith gave permission for cremation, later incorporated into the revised Code of Canon Law of 1983 (Canon No. 1176), as well as into the Order of Christian Funerals.

## COLUMBARIUM FAQs

You do not have to be a parishioner at Mercy to be inurned in the Garden of Peace Columbarium. Many niches have already been purchased by people outside of Mercy's parish. The priest or deacon from your home parish is welcome to preside at the committal of your cremains.

You do not have to be Catholic to have your ashes inurned in the Garden of Peace Columbarium. The non-Catholic decedent may have a minister from their faith perform the committal service with prior pastoral approval from Our Lady of Mercy.

For more information:

Michelle Schroeder:  
[michelle.schroeder@olomchurch.com](mailto:michelle.schroeder@olomchurch.com) or 225.926.1883





# OUR LADY of MERCY

## GARDEN OF PEACE

Adjacent to the Adoration Chapel and Church, the Garden of Peace is comprised of four walls named for the four evangelists: Matthew, Mark, Luke, and John. The center of the columbarium has a covered pavilion for services to be held. Fountains with exquisite mosaics are found on the Luke and John walls. Entry gates, locked nightly, are located on the Mark and Matthew walls.

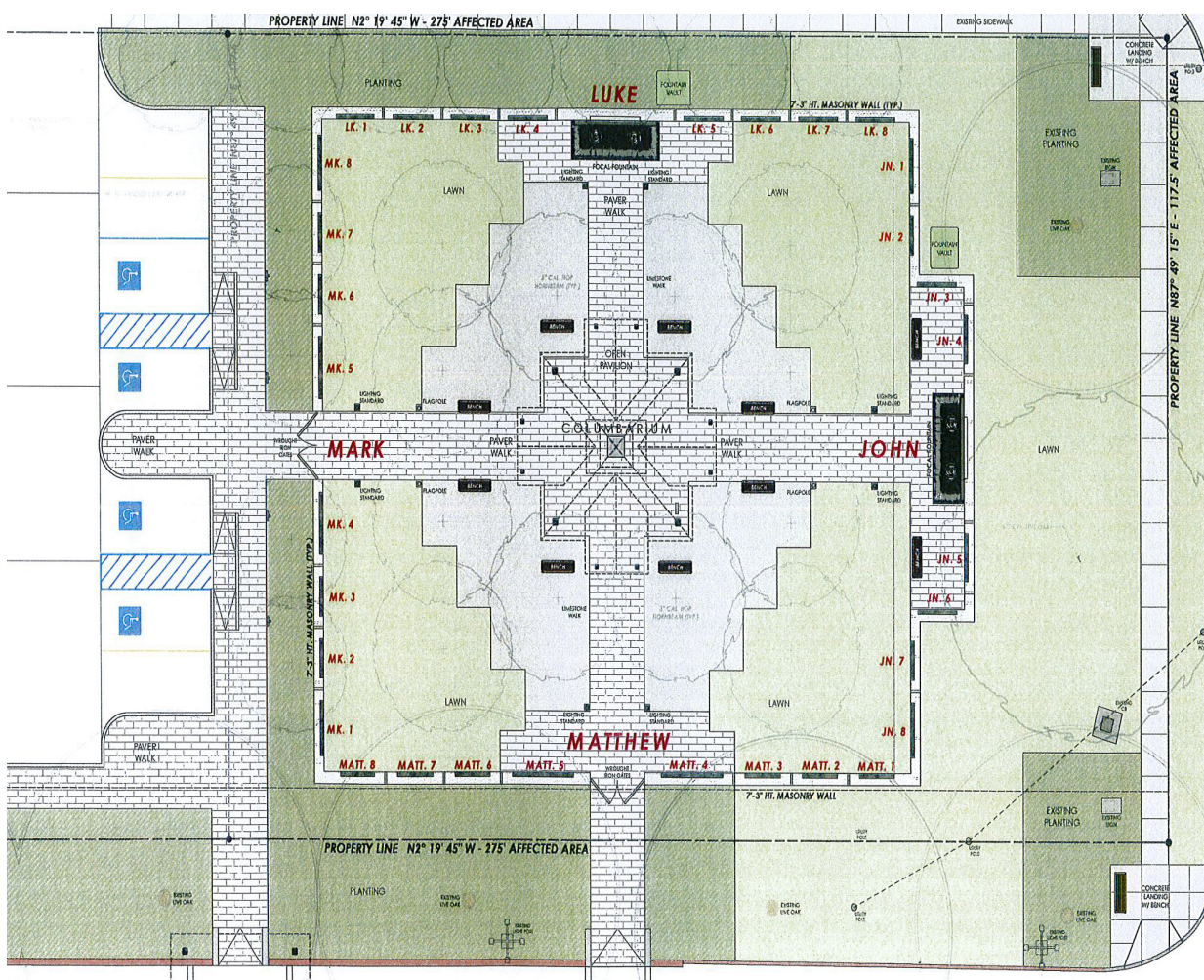

Urns are included in your purchase. If a different urn is chosen, it is the responsibility of the niche owner or the Executor of the Estate to verify that the urn meets the size guidelines.

Once payment is made and the Certificate of Title is signed, no refunds can be issued. Owners may transfer or sell ownership rights to niches provided the transfer/sale is made through the Congregation of Our Lady of Mercy Catholic Church. All transfers or sales must be notarized to be valid.